

WOLF heat pumps CHA, CHC and FHA series via Link Home and Pro - Commissioning

This brief installation instruction provides a quick overview of all the necessary steps. Additional information, safety instructions, references, and sources can be found in our [HelpCenter](#). The Installation instructions are only valid for the integration of the energy management system and the configuration of relevant assets. Make sure to carefully read the **safety instructions** and adhere to the **infrastructural requirements for a gridBox gateway installation**.

Required:

- Latest firmware, at least 5.00 (older fw versions do not support EEBus)
- WOLF SmartSet App or SmartSet Portal
- WOLF heat pump CHA, CHC or FHA series



| | LPC, MPC | OHPCF |
|---|----------|-------|
| CHA series (CHA-07, CHA-10, CHA-16/20, CHA-20/24) | X | X |
| CHC series (CHC-07, CHC-10) | X | X |
| FHA series (FHA-05/06, FHA-Center-05/06, FHA-06/07, FHA-Center-06/07, FHA-08/10, FHA-Center-08/10, FHA-11/14, FHA-Center-11/14, FHA-14/17, FHA-Center-14/17) | X | X |

Connection

1. Connect the heat pump to the communication module Link home / pro.
2. Connect the gridBox to the local Ethernet using an Ethernet cable.

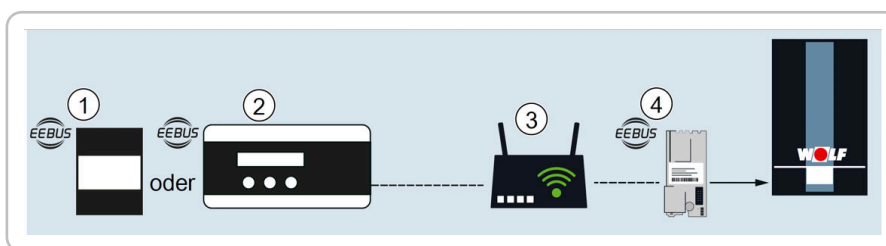

- | | |
|-----------------|----------------------------------|
| 1 Control box | 2 Energy management system (EMS) |
| 3 Local network | 4 WOLF Link home/pro |

Configuration

Enable EEBus communication



TIP

Check out the WOLF commissioning video: [EEBUS Aktivierung | Schnittstellenmodul Link home & Smartset App | WOLF](#)

1. Log in to the WOLF SmartSet App.
2. Click on **Profile**
3. Within the profile, click on **System list**.

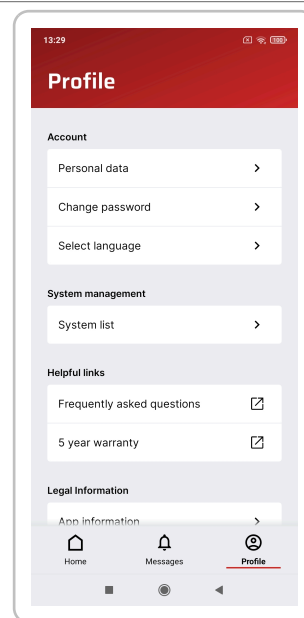
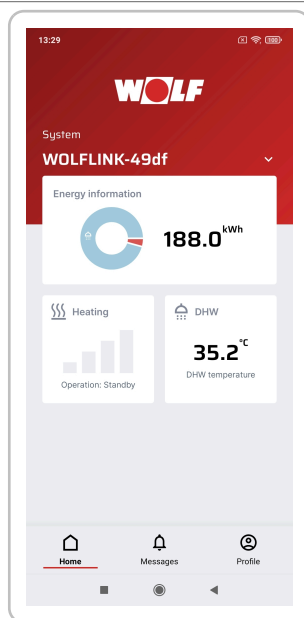

4. Click on the WOLF Link device and go to **Settings** → **EEBus**.

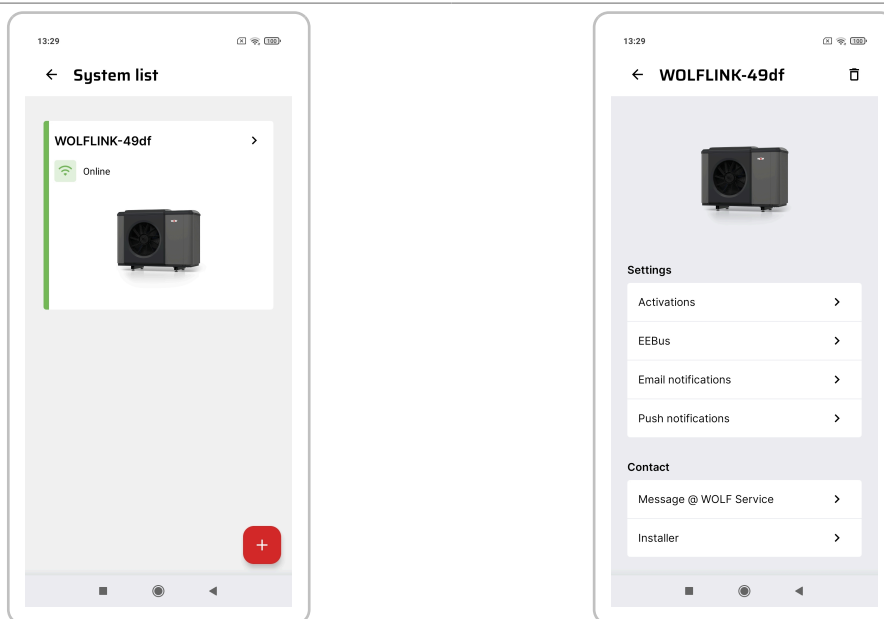

5. In the section **Communication**, enable **EEBus** by activating the slide switch.
6. Click on the **Refresh** button.

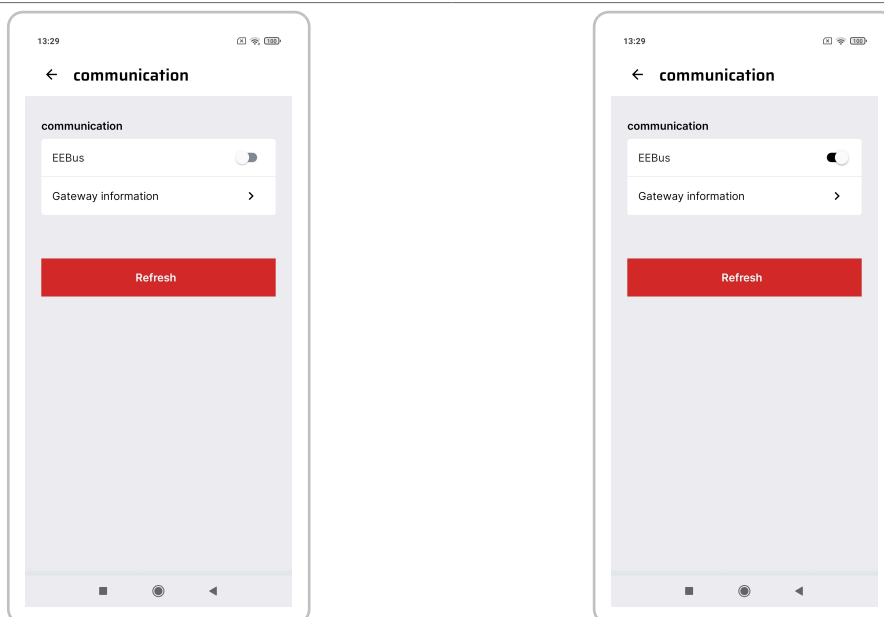

7. Switch back to the gridX installation Wizard.

Register the heat pump in the commissioning wizard

After the commissioning of the heat pump, follow the gridBox commissioning steps. If the heat pump is found during the scan, it is displayed in the wizard.

1. Depending on how the heat pump is connected, select
 - **Consumption meter**, if it is connected directly to the household meter or
 - **Additional meter**, if the heat pump meter is located somewhere else than the household meter.

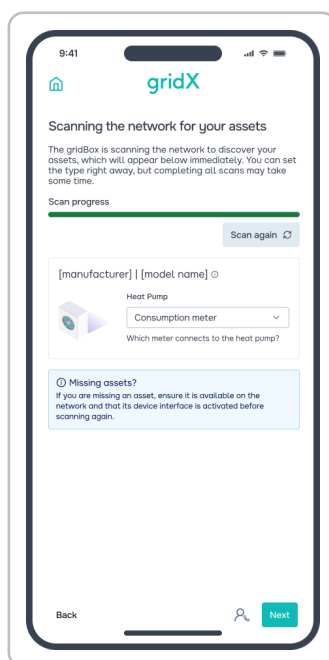

2. To initiate pairing, click the **Pair** button. The button then changes to show the **Cancel** option.
3. The pairing is successful when the button changes to **Decouple**.

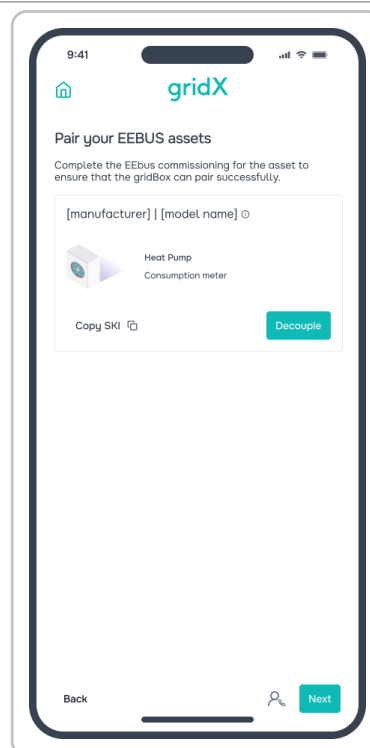
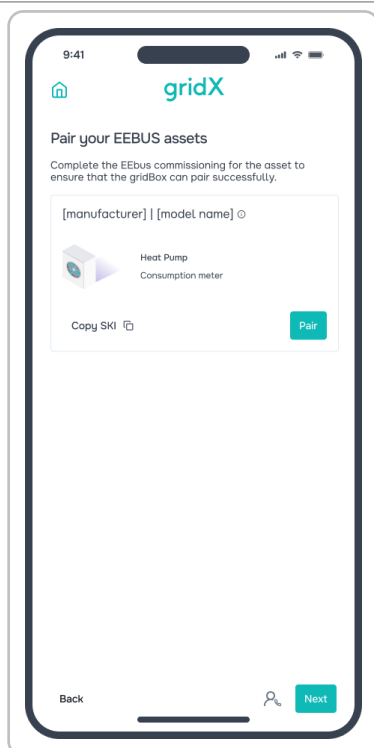

Trust the connection to the EMS in the WOLF app/portal

1. Go back to the WOLF SmartSet App
2. Go to the section **Communication – EEBus**.
3. Click on the button **Refresh**. The gridBox should be displayed in the section **detected EEBus devices**.

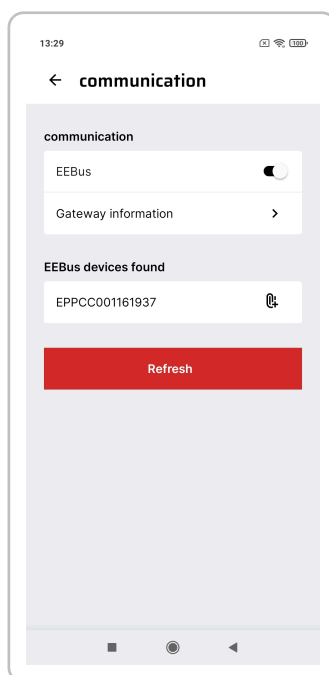

4. Select the detected asset and navigate to the view **Connected device**.
5. Scroll to the bottom of the page and click on **Trust Device**. Afterwards, the button displays Distrust the device.

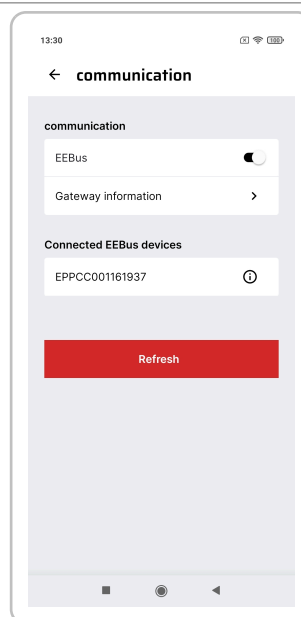
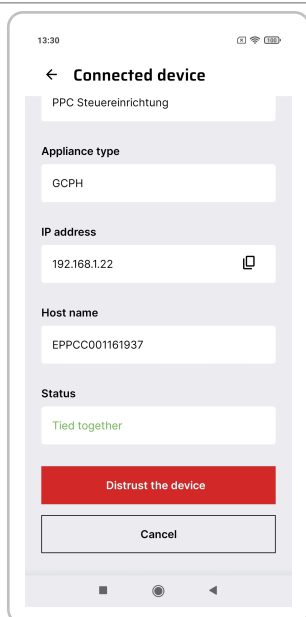

6. If the connection was successful, the gridBox is displayed in the section **Connected EEBus-Devices**.

Necessary HP-EMS-settings

For efficient control of the WOLF heat pump by the gridX-EMS, it is essential to ensure that the heat pump temperature settings allow sufficient flexibility. This is a mandatory prerequisite to, e.g. be able “store” available PV-surplus-energy “for later use” by overheating the DHW storage. If the temperature settings are not configured correctly, EMS use cases may not work.

Configure the heat pump according to the possibilities of the installed system. You can find guidance for these configurations in the WOLF planning document ‘Energiemanagement der Wärmepumpe Pla-

nungsunterlage 10/2025', section 'Beispiele für die Parametrierung der Wärmepumpe bei Einbindung von PV-Anlagen und dynamischen Tarifen'.¹

¹<https://www.wolf.eu/de-de/professional/downloads/downloadcenter?selection=nergiemanagement%E2%80%8B+der%E2%80%8B+W%C3%A4rmepumpe%E2%80%8B+Planungsunterlage+10%2F2025>